

**Aluminum Connectors Non Tension
DIN: 46267**

For Aluminum Conductors DIN: 48201 and Pre-rounded Sector Shaped Conductors

- Electrolytic high conductivity aluminum

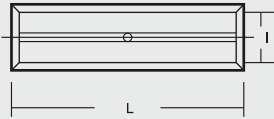

Product Ref.	Conductor Size mm ²		Dimension mm	
			I	L
AT 10	10	--	5	55
AT 16	16	25	5.5	55
AT 25	25	35	6.8	70
AT 35	35	50	8	85
AT 50	50	70	9.8	85
AT 70	70	95	11.2	105
AT 95	95	120	13.2	105
AT 120	120	150	14.7	105
AT 150	150	185	16.3	125
AT 185	185	240	18.3	125
AT 240	240	300	21	145
AT 300	300	--	23.3	145
AT 400	400	--	26	210
AT 500	500	--	29	210

Core Sector Shaped Conductor

Angle 120 degrees

- Aluminum and copper

